

Manual

Smart Outdoor 1080P Camera with Solar Panel (CSH-SLRODCAM | LSH-SLRODCAM)

1 GET THE APP  

QR Codes for
Downloading Apps

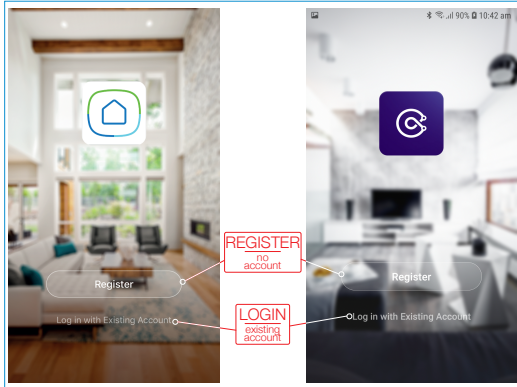
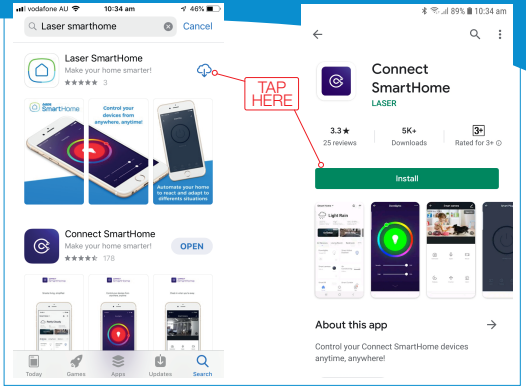

2 REGISTER OR
LOGIN TO APP

3 RECOMMENDED APP SETTINGS

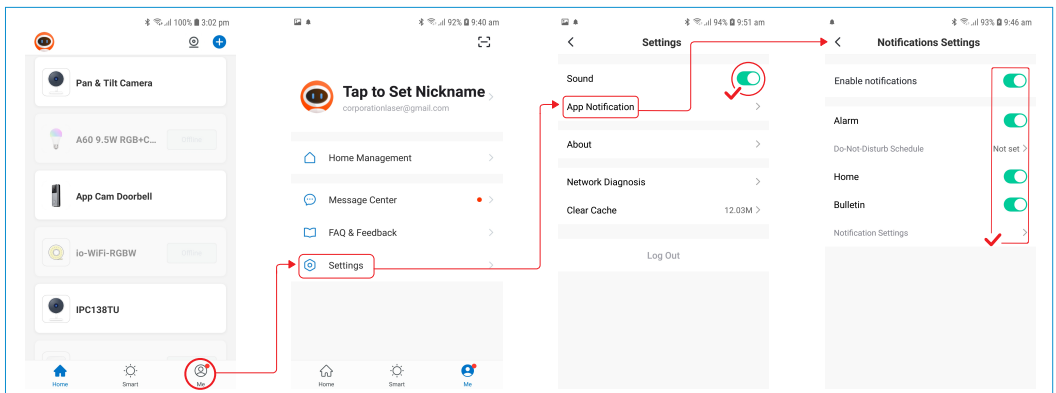

4 | POWERING CAMERA (2 Methods)



METHOD 1 POWER ADAPTER

TIP

Before first use please charge the Camera's Internal Battery approx 20 hours using a USB Power Adapter.
With a full charge Battery Life is approx 3 - 4 weeks (based on usage).



METHOD 2 SOLAR

With strong direct sunlight the Solar Panel will recharge the battery approx 5% every hour while also powering the camera

5 | MICRO SD CARD FOR MOTION DETECTION RECORDINGS (OPTIONAL)



6 | CONNECTING CAMERA TO APP

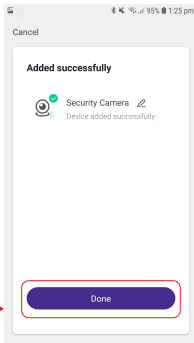
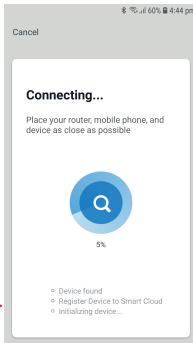
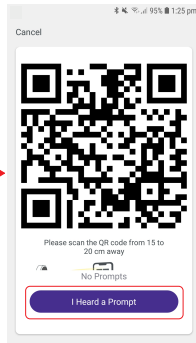
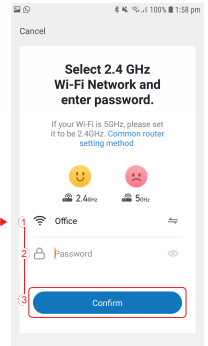
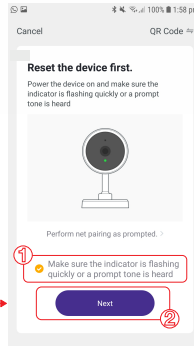
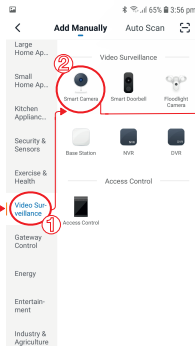
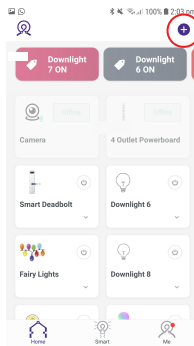
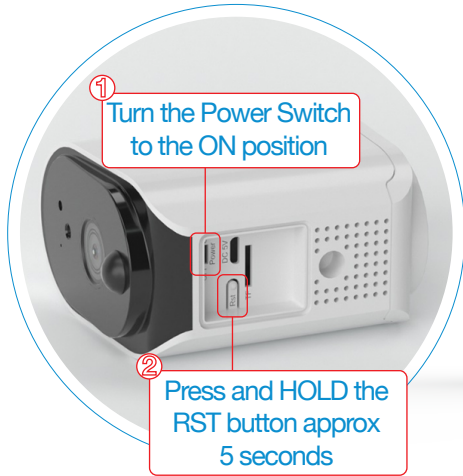

TIP

If device not found please check

2.4GHz 5GHz

Only 2.4G Wi-Fi networks are supported

7 | CAMERA SETTINGS

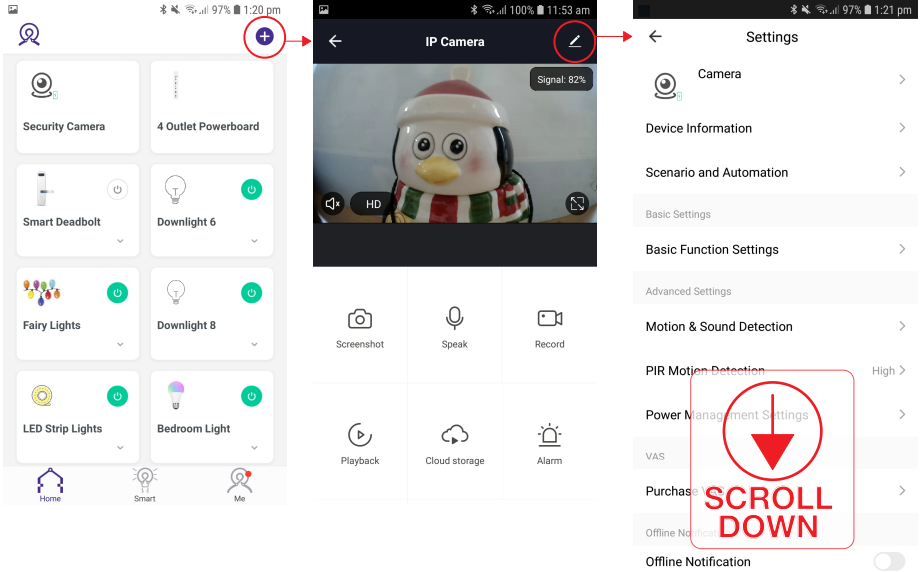

8 | REMOVING CAMERA



9 | USING CAMERA

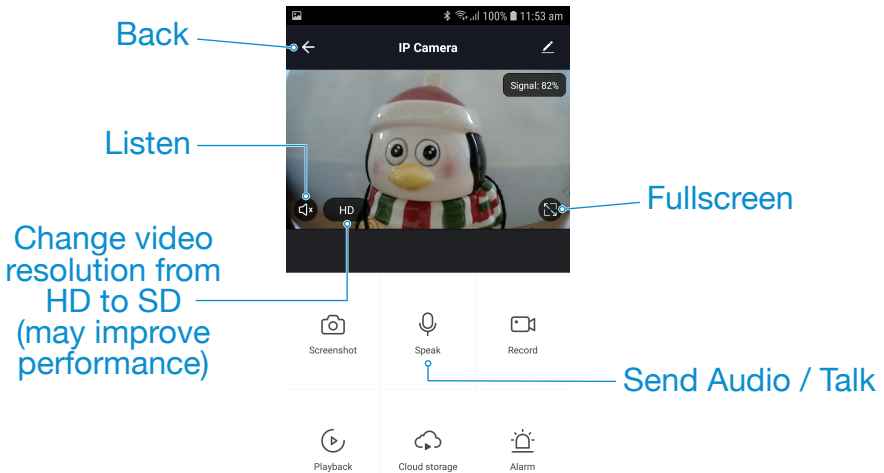

10 MOTION DETECTION



MOTION DETECTION SETTINGS

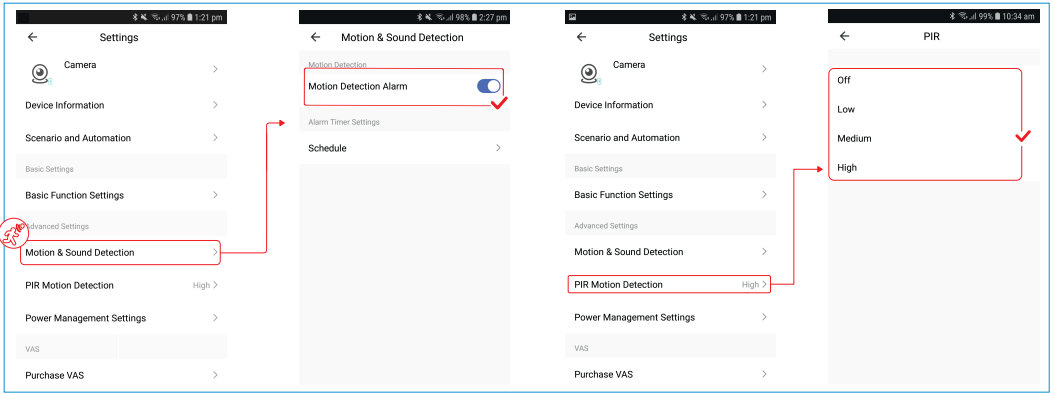

MOVEMENT DETECTED PHOTO

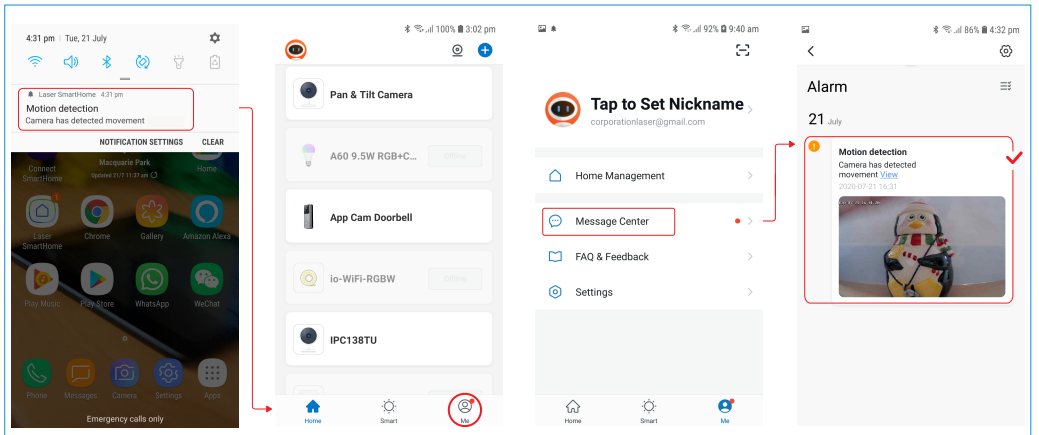

MOVEMENT DETECTED VIDEO

MICRO SD CARD REQUIRED

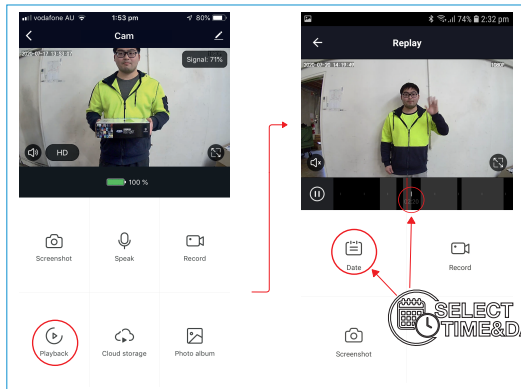

SELECT TIME&DATE

11 | OTHER FEATURES



TAKE SCREENSHOT

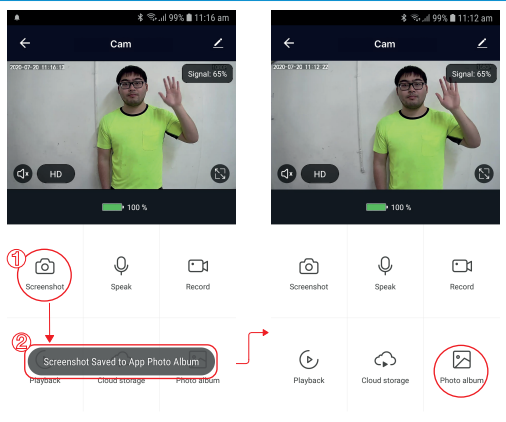

TAKE VIDEO

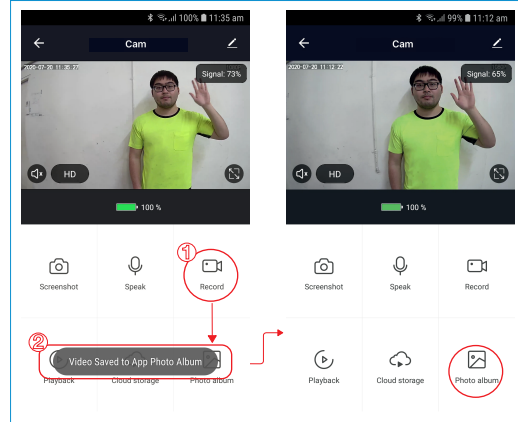

TROUBLESHOOTING

Device not connecting to App:

Please check your Wifi username and password are correct and you are only using 2.4Ghz Wifi connections as the 5Ghz band is not supported.

No Power when using Solar Panel:

Make sure the device has approx 30% power before using with Solar Panel. With strong direct sunlight the Solar Panel will recharge the battery approx 5% every hour while also powering the camera.

Micro SD Card is not recognised:

Make sure the Micro SD Card is 32gb or less. Check Micro SD Card has been formatted to the FAT32 or exFAT file system. If not please format on a Windows based computer.

For more helpful guides visit us at



LASER

www.youtube.com/LasercoAu

CONNECT

www.youtube.com/channel/UCCYzBiADapJN55Zzp3yfvLQ



WARRANTY

Our goods come with guarantees that cannot be excluded under the Australian Consumer Law. You are entitled to a replacement or refund for a major failure and compensation for any other reasonably foreseeable loss or damage. You are also entitled to have the goods repaired or replaced if the goods fail to be of acceptable quality and the failure does not amount to a major failure.